

Easy Swing[®]

"The Original" No Spring
Self Closing Double Action
Traffic Doors

Custom Built For Use In:

SUPERMARKETS

RESTAURANTS

RETAIL STORES

HOSPITALS

HOTELS & MOTELS

SHOPPING MALLS

WALK-IN COOLERS

RENTAL OUTLETS

CONVENIENCE STORES

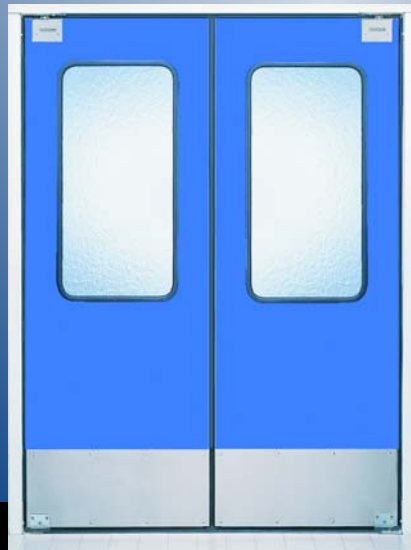

ELIASON[®]
CORPORATION

Door Application Matrix

ELIASON® Easy Swing® DOORS

1-800-828-3655-MI

1-800-828-2655-CA

	SALES / STOCK	DELI & FAST FOOD	FREEZER	WALK-IN COOLER	PERSONNEL	RESTAURANT	FOOD PROCESSING	SPECIALTY STORE
pg. 3-4 HEAVY TRAFFIC DOORS								
HCP-10	✓						✓	✓
HCP-10L	✓						✓	
HCG-10	✓			✓			✓	
HFG-10	✓			✓			✓	
PMP-2	✓	✓					✓	✓
SCP-2	✓						✓	
FMP	✓	✓					✓	✓
pg. 5 MEDIUM TO HEAVY TRAFFIC DOORS								
SCP-3		✓			✓	✓		✓
SCP-5	✓						✓	✓
SCP-7	✓	✓			✓	✓	✓	✓
pg. 6 LIGHT TO MEDIUM TRAFFIC DOORS								
LWP-3	✓	✓			✓	✓		✓
LWP-3L	✓							
LWP-5	✓	✓			✓	✓		✓
pg. 7-8 COOLER DOORS								
HFG-11	✓			✓			✓	
HFG-10	✓			✓			✓	
FCD	✓		✓	✓			✓	
SCG-1		✓		✓			✓	✓
FCG-1				✓			✓	
SCG-3		✓		✓			✓	✓
FCG-3				✓			✓	
SCG-5		✓		✓			✓	✓
FCG-5				✓			✓	
pg. 9-10 FOOD SERVICE DOORS								
SCP-8	✓	✓			✓	✓		✓
SCP-6	✓	✓			✓	✓		✓
LWP-6	✓	✓			✓	✓	✓	✓
SCP-CAFE		✓			✓	✓	✓	✓
P-11 PLUS	✓	✓			✓	✓	✓	✓
DSP-3		✓			✓	✓	✓	✓
SCP-4	✓	✓			✓	✓	✓	✓
(PAGE 4) PMP-GATE		✓			✓	✓	✓	✓
pg. 11 HARDWARE AND ACCESSORIES								
pg. 12 JAMB CONSTRUCTION DETAIL								

HOW TO BUY:

Eliason *Easy Swing*® doors and other quality products can be purchased direct or from a supplier of your choice. Net terms are available, subject to credit approval. F.O.B. Factory. Visa, MasterCard and Discover are accepted.

WARRANTY:

Two-year warranty that products are free of defects in material and workmanship. We will replace (exclusive of freight and labor) parts proven defective within two years after date of shipment to purchaser. Defective parts must be returned to the manufacturer.

High Impact Traffic Doors

08 38 00 / ELI
BuyLine 2989

These doors are engineered and built for customers seeking optimum durability. The HC and HF series will stand up to the everyday challenges from the abusive traffic of pallet jacks, dollies and hand trucks. HC doors are used in supermarkets, warehouses, manufacturing facilities and more. Order by the finished opening size.

MODEL: HCP-10 / HCG-10

SPECIFICATIONS

Door Body: Polymer cell core with a high strength structural PVC frame, 1-1/2" total door thickness

Finish: .125" thick high-impact thermoplastic exterior

Window: 14" x 16" clear acrylic, double glazed set in black rubber molding

Gasketing (HCG-10 ONLY): Perimeter seal

Easy Spring Bumper: 18" high (both sides) or **Optional** 24" high scuff plate (both sides)

Shown with Optional: 5" x 18" Jamb Guards with heavy duty bottom leaf

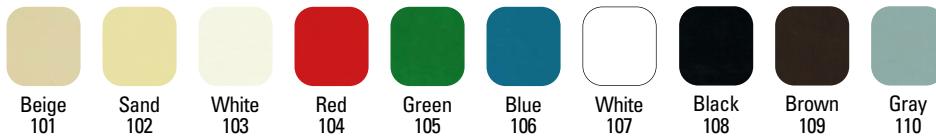

MODEL: HCP-10L

SPECIFICATIONS

Door Body: Polymer cell core with a high strength structural PVC frame, 1-1/2" total door thickness

Finish: .125" thick high-impact thermoplastic exterior

Window: 14" x 16" clear acrylic, double glazed set in black rubber molding

Easy Spring Bumper: 42" high (both sides)

Jamb Guard: 3" x 9" with heavy duty bottom leaf

Shown with Optional: 14" x 16" ABS window frames

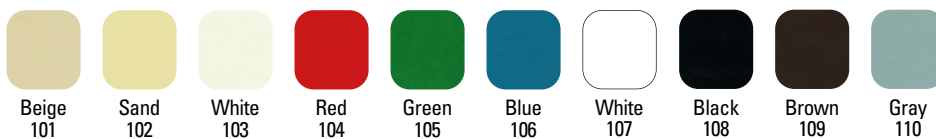

Detail of ABS Window Frame

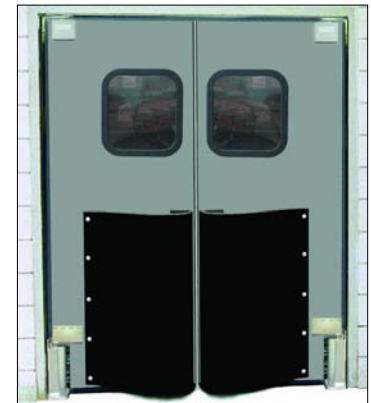

MODEL: HFG-10

SPECIFICATIONS

Door Body: Urethane foam core with a high strength structural PVC frame, 1-1/2" total door thickness

Finish: .125" thick high-impact thermoplastic exterior

Window: 14" x 16" clear acrylic, double glazed set in black rubber molding

Gasketing: Perimeter seal

Easy Spring Bumper: 18" high (both sides) or **Optional** 24" high scuff plate (both sides)

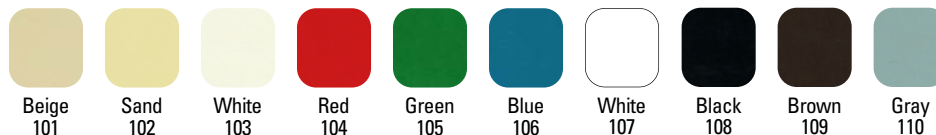

OPTIONAL HARDWARE AND ACCESSORIES - see page 11

High Impact Traffic Doors

ADDITIONAL APPLICATIONS:

- Wholesale Operations
- Manufacturing Facilities
- Commissaries
- Distribution Centers
- Home Centers
- Food Processing Plants



MODEL: PMP-2

SPECIFICATIONS

Door Body: 1/4" thick (double ply 1/8" ABS material), 3/4" total door thickness throughout the impact area

Finish:

- **Surface:** Textured (both sides)
- **"One Piece":** 1/4" thick ABS base plate and back spline (both sides)
- **Back Channel:** 16 gauge stainless steel

Window: 14" x 16" clear acrylic set in black rubber molding

Shown with Optional: 14" x 16" ABS window frames

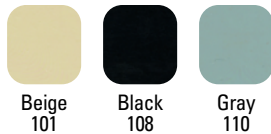

Maximum height 47"



PMP-GATE



MODEL: SCP-2

SPECIFICATIONS

Door Body: 3/4" exterior grade solid wood core, 1" total door thickness

Finish:

- **Top Panel:** .032" tempered aluminum alloy with satin anodized finish (both sides)
- **Base Plate:** 48" high, 16 gauge stainless steel (front), galv. steel (rear) - through riveted
- **Back Channel:** 14 gauge, grade "D", mill galvanized steel

Window: 9" x 14" clear acrylic set in black rubber molding



MODEL: FMP

SPECIFICATIONS

Door Body: Double ply .120" vinyl sheets, .240 total door thickness

Finish: Gloss, pebble embossed

Window: 14" x 16" clear vinyl

Hardware: Top mounted, No bottom pivot

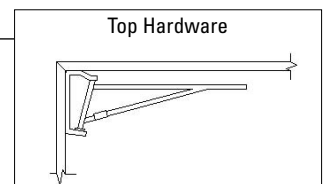
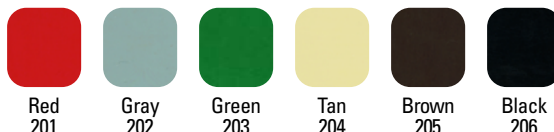

OPTIONAL HARDWARE AND ACCESSORIES - see page 11

These solid core doors are perfect for medium to heavy impact traffic doorways. For use in both retail and commercial applications where the traffic is heavy and decorative durable doors is a necessity. Supermarkets, restaurants, bars and rental outlets are just a few applications. Consider these doors where pressure differential might hold lighter doors partially open. Order by the finished opening size.

MODEL: SCP-3

SPECIFICATIONS

Door Body: 3/4" exterior grade solid wood core, 1" total door thickness

Finish:

- **Surface:** 18 gauge full length stainless steel panel (both sides)
- **Back Channel:** 18 gauge stainless steel

Window: 9" x 14" clear acrylic set in black rubber molding

Shown with Optional: 15" x 20" clear acrylic window



MODEL: SCP-5

SPECIFICATIONS

Door Body: 3/4" exterior grade solid wood core, 1" total door thickness

Finish:

- **Top Panel:** .032" tempered aluminum alloy with satin anodized finish (both sides)
- **Center Plate:** 30" high, 18 gauge stainless steel (front), galvanized steel (rear)
- **Base Plate:** 18" high, 14 gauge, grade "D", mill galvanized steel (both sides)
- **Back Channel:** 14 gauge, grade "D", mill galvanized steel

Window: 9" x 14" clear acrylic set in black rubber molding

Shown with Optional: 9" x 14" ABS window frames

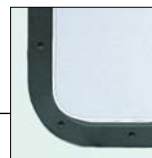

Detail of ABS Window Frame



MODEL: SCP-7

SPECIFICATIONS

Door Body: 3/4" exterior grade solid wood core, 1" total door thickness

Finish:

- **Top Panel:** .032" tempered aluminum alloy with satin anodized finish (both sides)
- **Base Plate:** 48" high, 18 gauge stainless steel (both sides)
- **Back Channel:** 18 gauge stainless steel

Window: 9" x 14" clear acrylic set in black rubber molding



OPTIONAL HARDWARE AND ACCESSORIES - see page 11

Light to Medium Traffic Doors

The LWP door series has proven to be the most economical, durable and long lasting over the years. Constructed from tempered aluminum these doors are semi-flexible and absorb the initial impact. Minimum 12" high base plates are required when ordering a decorative laminate finish. Used in convenience stores, retail outlets, department stores or as personnel doors. Order by the finished opening size.



MODEL: LWP-3

SPECIFICATIONS

Door Body: .063" thick tempered aluminum alloy with delta formed vertical edges

Finish: Satin anodized (both sides)

Window: 9" x 14" clear acrylic set in black rubber molding

Shown with Optional: 10" round translucent window

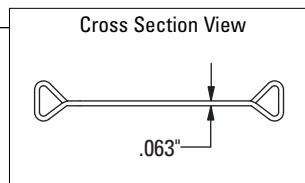

MODEL: LWP-3L

SPECIFICATIONS

Door Body: .063" thick tempered aluminum alloy with delta formed vertical edges

Finish:

- **Surface:** Satin anodized (both sides)
- **Base Plate:** 30" high, 18 gauge stainless steel (front), galvanized steel (rear)

Window: 9" x 14" clear acrylic set in black rubber molding

Jamb Guard: 3" x 9"



MODEL: LWP-5

SPECIFICATIONS

Door Body: .063" thick tempered aluminum alloy with delta formed vertical edges

Finish:

- **Laminate:** .032" decorative high pressure laminate (both sides)
- **Base Plate:** 12" high, 18 gauge stainless steel (front), galvanized steel (rear)
- **Bumper Strip:** Black aluminum, mounted 32" up from bottom of door

Window: 9" x 14" clear acrylic set in black rubber molding

Shown with Optional: 14" x 16" clear acrylic window

OPTIONAL HARDWARE AND ACCESSORIES - see page 11

These gasketed doors are designed for walk-in coolers and refrigerated processing areas. The SCG and HCG series should be used where the temperature differential is 10 to 30 degrees. The FCG, HFG-11 and HFG-10 series with foam insulation are used in temperature differential of 25 to 50 degrees. Gasketed doors are recommended for temperature and environmental control. Order by the finished opening size.

MODEL: HFG-11

SPECIFICATIONS

Door Body: Urethane foam core with a high strength structural PVC frame, 1-1/2" total door thickness

Finish: .125" thick high impact thermoplastic exterior (both sides)

Window: 14" x 16" clear acrylic, double glazed set in black rubber molding

Gasketing: Perimeter seal

Scuff Plate: 24" high, .090" thick, high impact thermoplastic (both sides)

Shown with Optional: 15" x 20" clear acrylic window

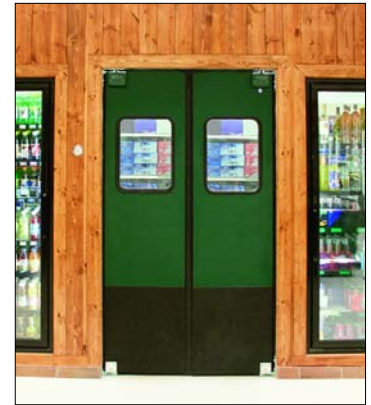
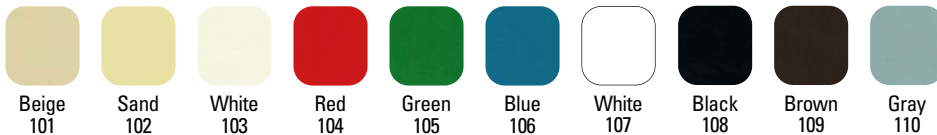

MODEL: HFG-10

SPECIFICATIONS

Door Body: Urethane foam core with a high strength structural PVC frame, 1-1/2" total door thickness

Finish: .125" thick high impact thermoplastic exterior

Window: 14" x 16" clear acrylic, double glazed set in black rubber molding

Gasketing: Perimeter seal

Easy Spring Bumper: 18" high (both sides) or **Optional** 24" high scuff plate (both sides)

Shown with Optional:

- 5" x 18" Jamb Guards with heavy duty bottom leaf
- 14" x 16" Flush Window, clear acrylic

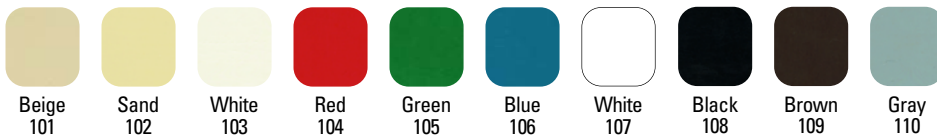

MODEL: FCD

SPECIFICATIONS

Door Body: Single ply .120" clear vinyl sheet

Hardware: Top mounted, no bottom pivot

Used as secondary door in freezers

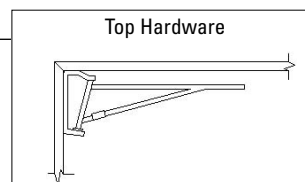

OPTIONAL HARDWARE AND ACCESSORIES - see page 11

Cooler Doors

ADDITIONAL APPLICATIONS:

- Computer Rooms
- Food Processing Plants
- Meat Prep. Rooms
- Environmental Control Rooms
- Produce Coolers
- Self-Service Beer Coolers



MODEL: SCG-1

SPECIFICATIONS

Door Body: 3/4" exterior grade solid wood core, 1" total door thickness

Finish:

- **Top Panel:** .032" tempered aluminum alloy with satin anodized finish (both sides)
- **Base Plate:** 48" high, 18 gauge stainless steel (both sides)

Window: 9" x 14" clear acrylic set in black rubber molding

Gasketing: Perimeter seal with adjustable bottom gasket

MODEL: FCG-1

SPECIFICATIONS

Same finish and gasketing as **SCG-1** with 1-1/2" foam insulated core and double glazed window



MODEL: SCG-3

SPECIFICATIONS

Door Body: 3/4" exterior grade solid wood core, 1" total door thickness

Finish: 18 gauge full length stainless steel panel (both sides)

Window: 9" x 14" clear acrylic set in black rubber molding

Gasketing: Perimeter seal with adjustable bottom gasket

Shown with Optional: 15" x 20" clear acrylic window

MODEL: FCG-3

SPECIFICATIONS

Same finish and gasketing as **SCG-3** with 1-1/2" foam insulated core and double glazed window



MODEL: SCG-5

SPECIFICATIONS

Door Body: 3/4" exterior grade solid wood core, 1" total door thickness

Finish:

- **Top Panel:** .032" tempered aluminum alloy with satin anodized finish (both sides)
- **Center Plate:** 30" high, 18 gauge stainless steel (both sides)
- **Base Plate:** 18" high, 14 gauge grade "D" mill galvanized steel (both sides)

Window: 9" x 14" clear acrylic set in black rubber molding

Gasketing: Perimeter seal with adjustable bottom gasket

MODEL: FCG-5

SPECIFICATIONS

Same finish and gasketing as **SCG-5** with 1-1/2" foam insulated core and double glazed window

OPTIONAL HARDWARE AND ACCESSORIES - see page 11

These doors are the most popular in the food service industry. Restaurant owners, architects and specification writers choose this series for its attractiveness and durability. Select from an unlimited number of decorative laminates to achieve the perfect look for your specific application. For use in restaurants, hospitals, sports bars and more. Order doors by finished opening size.

MODEL: SCP-8

SPECIFICATIONS

Door Body: 3/4" exterior grade solid wood core, 1" total door thickness

Finish:

- **Laminate:** .032" decorative high pressure laminate (both sides)
- **Base Plate:** 18" high, 18 gauge stainless steel (both sides)
- **Edge Trim:** 18 gauge stainless steel
- **Back Channel:** 18 gauge stainless steel

Window: 9" x 14" clear acrylic set in black rubber molding



MODEL: SCP-6

SPECIFICATIONS

Same specifications as **SCP-8** with a 48" high stainless steel base plate.

MODEL: LWP-6

SPECIFICATIONS

Door Body: .063" thick tempered aluminum alloy with delta formed vertical edges

Finish:

- **Laminate:** .032" decorative high pressure laminate (both sides)
- **Base Plate:** 12" high, 18 gauge stainless steel (both sides)

Window: 9" x 14" clear acrylic set in black rubber molding

Shown with Optional: 15" x 20" clear acrylic window



MODEL: SCP-CAFE

SPECIFICATIONS

Door Body: 3/4" exterior grade solid wood core, 1" total door thickness (max height 47")

Finish:

- **Laminate:** .032" decorative high pressure laminate (both sides)
- **Edge Trim:** Black plastic molding
- **Straight Cut:** Top and Bottom

Shown with Optional: Top and Bottom Contours
(sold as single or double leaf)



OPTIONAL HARDWARE AND ACCESSORIES - see page 11

Food Service Doors

ADDITIONAL APPLICATIONS:

- Dining Rooms
 - Retail Stores
 - Drug Stores
- Discount Stores
 - Department Stores
 - Variety Stores
- Hotels and Motels
 - Sporting Good Stores



MODEL: P-11 PLUS

SPECIFICATIONS

Door Body: 1/2" thick polymer cell core with 1/2" solid ABS frame, 3/4" total door thickness

Finish:

- **Surface:** .125" thick high impact thermoplastic exterior (both sides)
- **Back Channel:** 14 gauge galvanized, powder coated satin back

Window: 14" x 16" clear acrylic set in black rubber molding



Shown with Optional: Window centered in door

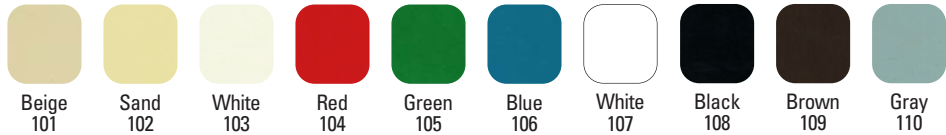

MODEL: DSP-3

SPECIFICATIONS

Door Body: 16 gauge stainless steel with delta formed vertical edges

Window: 9" x 14" clear acrylic set in black rubber molding

Shown with Optional: Diamond shape translucent acrylic window

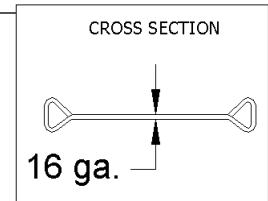

MODEL: SCP-4

SPECIFICATIONS

Door Body: 3/4" exterior grade solid wood core, 1" total door thickness

Finish:

- **Surface:** .032" aluminum full length panels with satin anodized finish (both sides)
- **Base Plate:** 12" high, 18 gauge stainless steel (both sides)

Window: 9" x 14" clear acrylic set in black rubber molding

Shown with Optional:

- 24" x 30" translucent acrylic window
- .032" high pressure laminate

OPTIONAL HARDWARE AND ACCESSORIES - see page 11

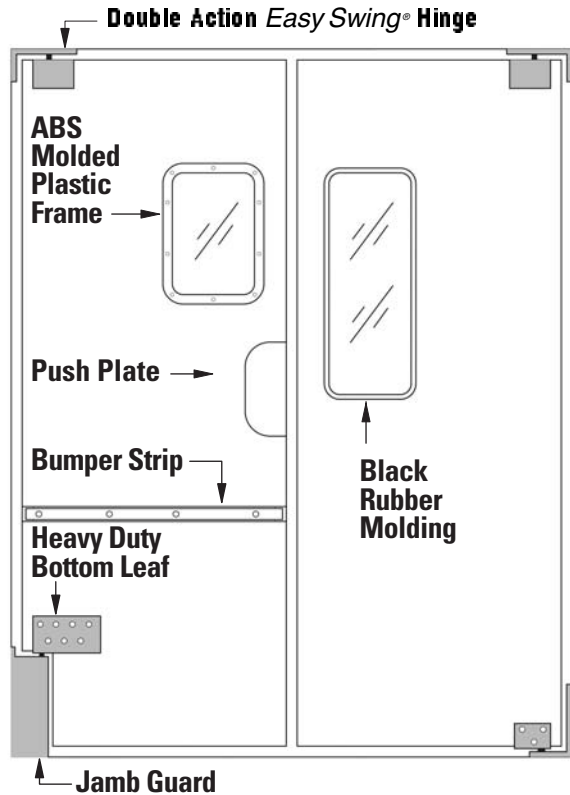

HARDWARE:

The original double action *Easy Swing*® hinge by Eliason Corporation supplied with every door. Pre-assembled with all necessary fasteners needed for a fast and easy installation. Opens with little effort and closes automatically. Top mounted hinges are standard with models FCD and FMP doors.

LOCK:

May be used with single leaf solid wood core doors. Toggle switch on inside and key entry on outside of door.

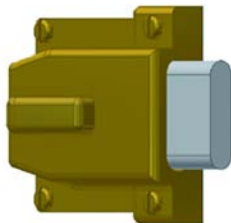

BUMPER STRIPS:

Tempered, extruded aluminum alloy 3/4" x 1-1/2" thick satin or black anodized (LWP series only). Black anodized strips for all other models. Use at point of impact for decor protection.

Side View

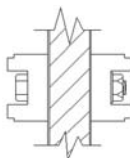

PUSH PLATES:

Manufactured from stainless steel or ABS plastic. Push plates are a functional item that adds a professional look to any door.

WINDOWS:

Clear acrylic set in black rubber molding is the standard for most doors. Windows are available in a variety of material, shapes and sizes. Consult Eliason's Customer Service department for details.

FLUSH WINDOWS:

Double glazed clear acrylic 14"x16" window set into a pre-formed PVC inner frame. Flush windows add a clean smooth look to our HCP, HCG and HFG models



WINDOW FRAMES:

High impact plastic molded window frames available for 9" x 14" or 14" x 16" windows upon request.

HEAVY DUTY BOTTOM LEAF:

Standard on HCP, HCG and HFG with jamb guards. Also Provides additional strength for any of our HC doors with or without jamb guards.



JAMB GUARDS:

For high impact traffic areas. Protects door frame and bottom hardware. Available in 3" x 9" or 5" x 18".

3" x 9" Jamb Guard



5" x 18" Jamb Guard

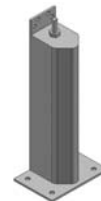

SPRING BUMPERS:

Flexible, impact resistant, thermoplastic material. Used to protect the door finish in abusive traffic areas. Offered in a variety of colors and sizes. Highly recommended in heavy traffic openings.



Jamb Construction Details

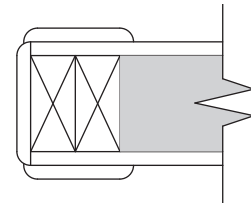
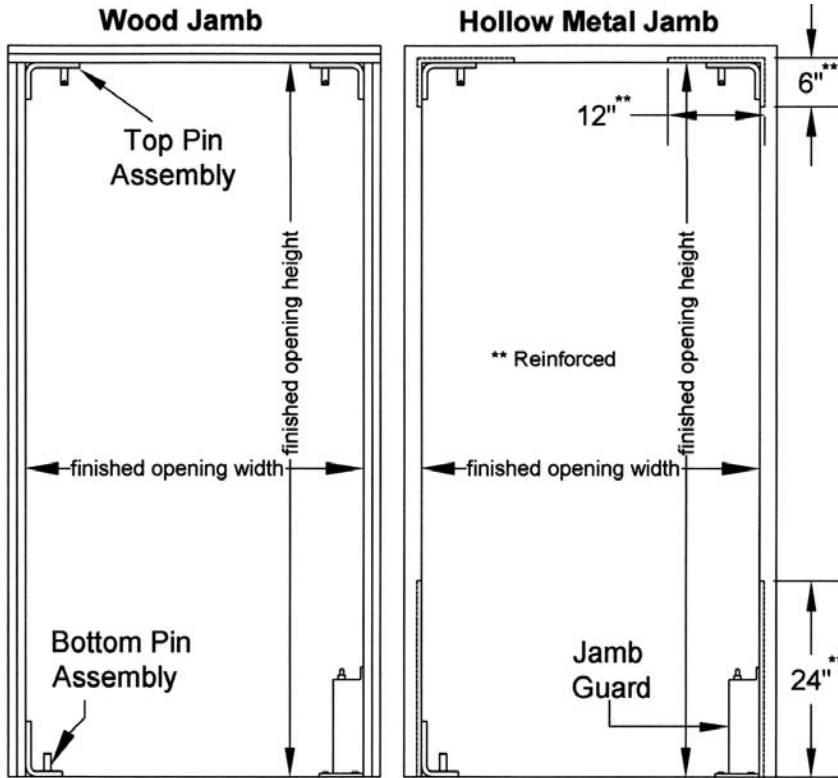

Wood Jamb
(double 2 x 4 construction is needed for top and side jambs)

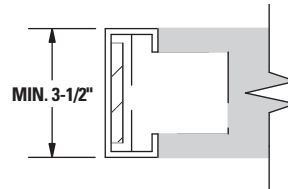

Hollow Metal Jamb
(reinforced at hardware location)

Note: Finished opening must be square and plumb for proper door operation.

Warning: The warranty will become void if protective posts are not used in motorized traffic applications.

FASTENERS SUPPLIED:

- #14 x 1-1/2" philip flat head sheet metal/wood screws (countersink)
- 1/4"-20 x 1" philip flat head thread cutting screws (countersink)



Eliason also manufactures energy saving EconoCovers[®] for information call 866-800-4218.



Manufactured only in the U.S.A.



© Eliason Corporation. All rights reserved. D-07

ELIASON[®]
CORPORATION

Easy Swing[®] "The Original" No Spring Self Closing Double Action Traffic Doors

www.eliasoncorp.com | www.restaurantdoors.net
www.supermarketdoors.net

**MICHIGAN SALES OFFICE:
(HEADQUARTERS)**

P.O. Box 2128
Kalamazoo, MI 49003 USA

TELEPHONE:
800-828-3655 | 269-327-7003

FAX:
800-828-3577 | 269-327-7006

E-MAIL:
doors@eliasoncorp.com

CALIFORNIA SALES OFFICE:

P.O. Box 1026
Woodland, CA 95776 USA

TELEPHONE:
800-828-2655 | 530-662-5494

FAX:
800-662-5192 | 530-662-5192

E-MAIL:
doors@eliasonwest.com